

GYPSONIC GRG PERFORATED WALL PANELS GI FRAME (SEAMLESS-JOINTLESS SYSTEM) FOR WALL

All Dimension are in mm

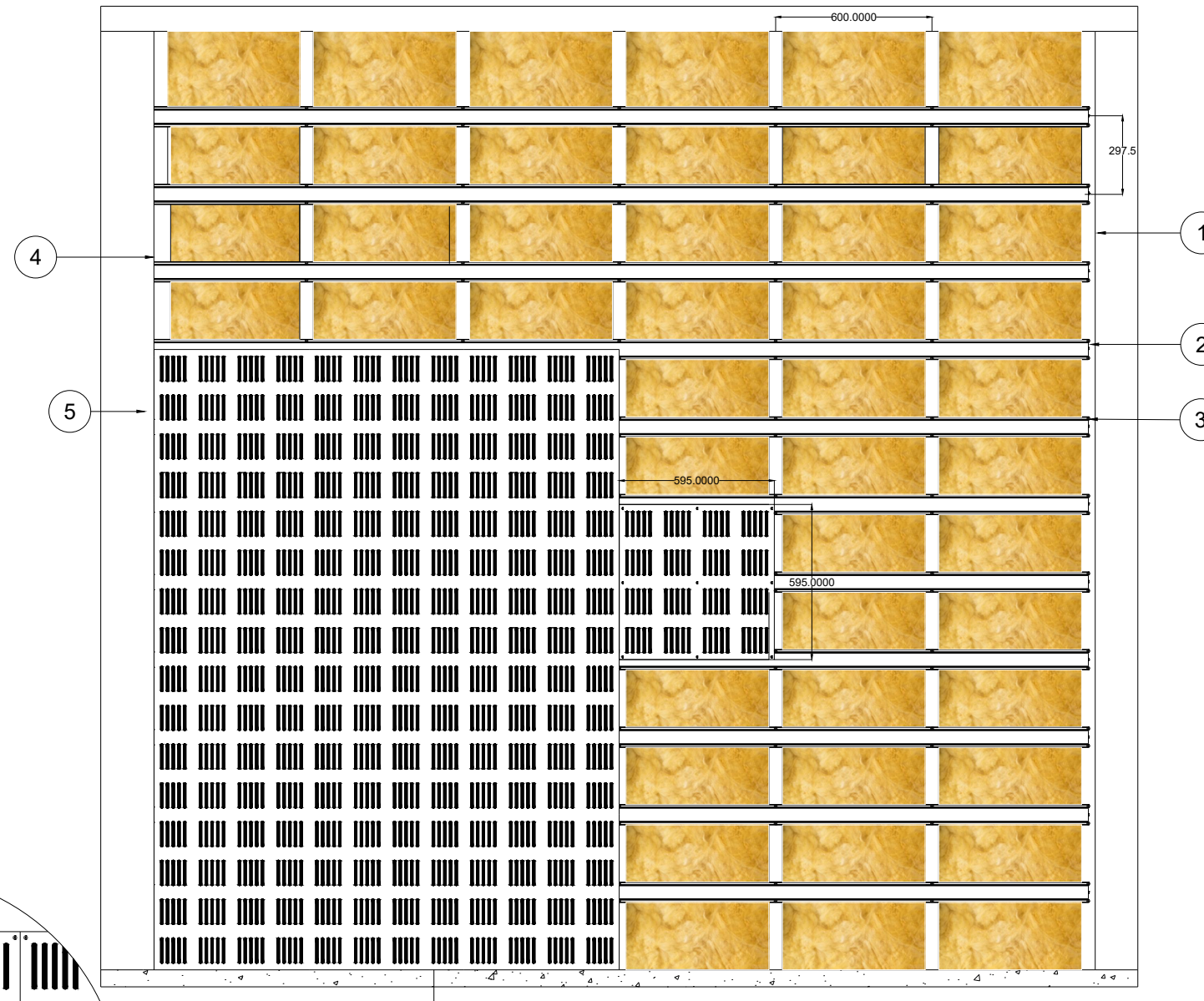
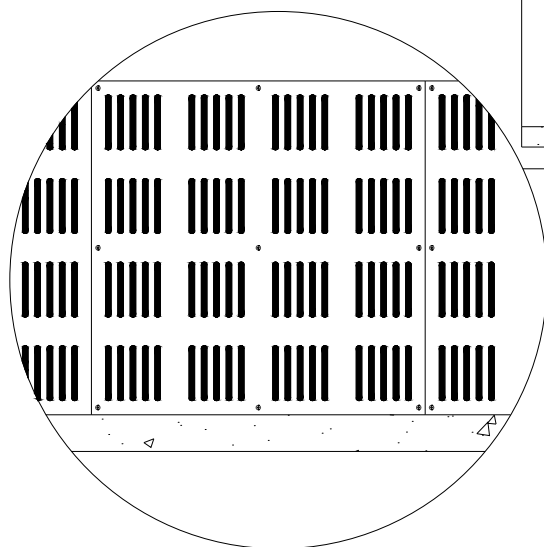
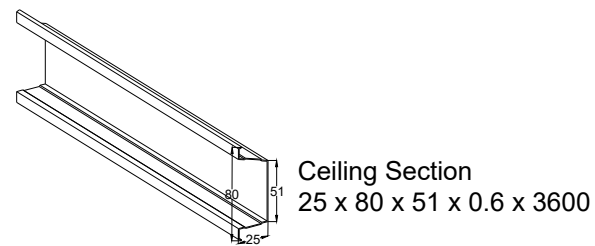
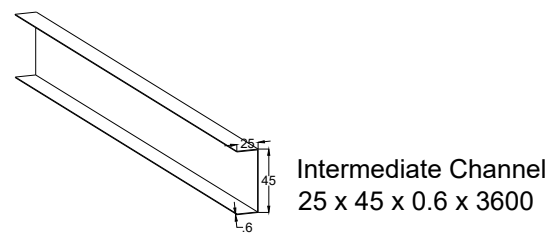
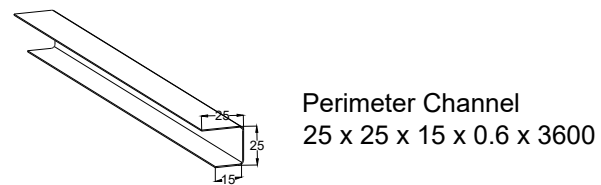

Specification of Components

- 1 Intermediate Channels
- 2 Ceiling Section
- 3 Screw
- 4 Mineral wool
- 5 GYPSONIC Acoustic Tiles

WALL- INSTALLATION GUIDELINES

Installation (for carpenters):

- A suitable wall structure is chosen based on meeting the necessary requirements for fire, light, sound insulation and wall height. The chosen wall is built and used as a base for the acoustic wall cladding.

- Shape the 45mm x 15mm & 1mm thick Intermediate (Bottom) and fix it to the wall at a maximum screw distance of 600 mm.

- Shape and fix horizontally the 85mm x 25mm & 1mm thick G.I. Ceiling Section at a maximum screw distance of 297.5 mm. The distance between the horizontal G.I. Ceiling Section sections is 297.5 mm.

- Shape Glasswool / Rockwool between the ready framed structures. To keep the glasswool /rockwool placed perfectly use chicken mesh with help of G.I. wire.

- Fix Gypsonic panels vertically with the help of 9 self-threading screws overall the panel , so that any short board edges are connected over the G.I. Ceiling Section.

Finishing (for painters/finishers):

- Use any normal casting gypsum powder paste as a joint filler to close all joints.
- All joints, screw holes and edges are plastered until a smooth and even surface is achieved
- Painting is done by priming two coats of finish with a smooth roller